

Hello,

You are receiving this message to let you know that you now have a parent account in Canvas with the role of observer. The observer role allows you to access your student's courses, but you will not be able to affect any course data or participation. Observers cannot submit work on behalf of the students they observe, but they can see student grades, assignments and events, and course interactions.

You can login to your Canvas account at: [ferndaleps.instructure.com/login/canvas](https://ferndaleps.instructure.com/login/canvas) (please be sure your browser does not truncate this url. Chrome has a tendency to remove the /login/canvas from the end which will prevent you from making an initial login)

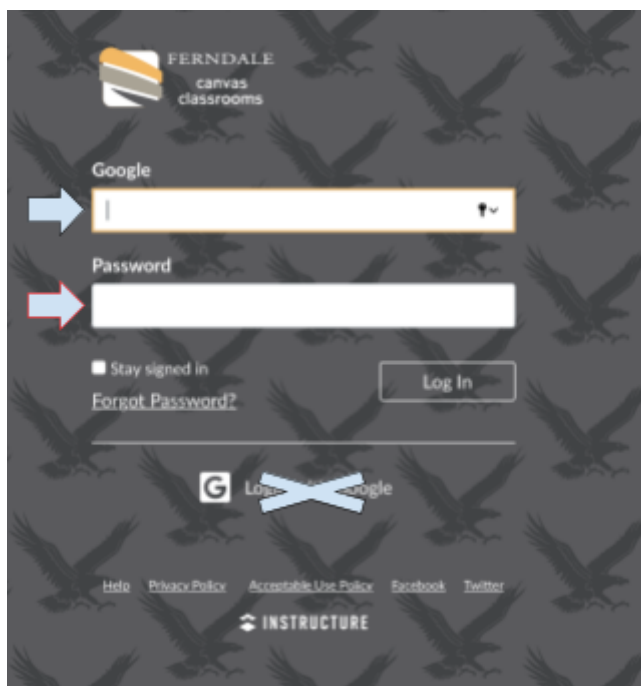

Once you are on this webpage you can access your account by using the same email address that you used during enrollment and that is entered in MiStar (or that you included on the “Need a Canvas Parent Account?” Google form. If you do not see a screen that looks like the screenshot below, please double check the web address. Your initial password is **FPSfamily!** (the exclamation point is a part of the password)

Unlike your students who “Login with Google”, you will need to enter your email (one that you’ve submitted at enrollment and password in the boxes). You will not be able to use the “Login with Google” feature, even if you have a gmail account.

When you login, you will be at your Dashboard and will be able to see your student's classes and upcoming assignments. To view specifics of a class, click on the tile for that class.

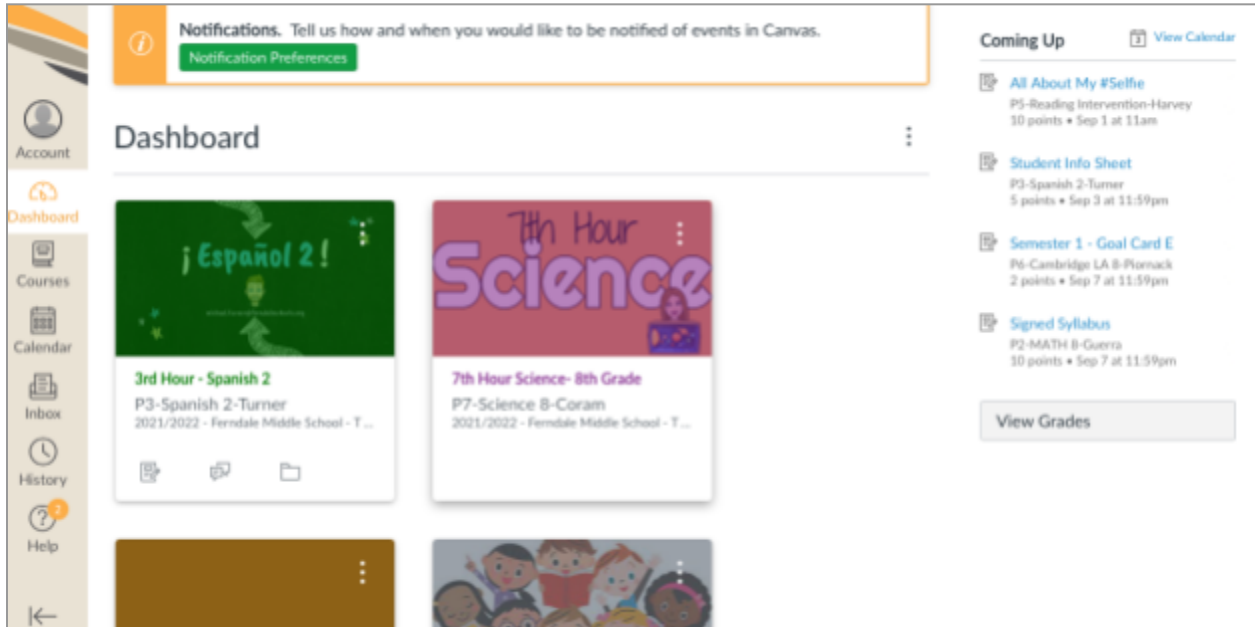

If you would like to reset your password, click the Forgot Password? button or send an email to Tom Maes ([john.maes@ferndaleschools.org](mailto:john.maes@ferndaleschools.org)) requesting a new password.

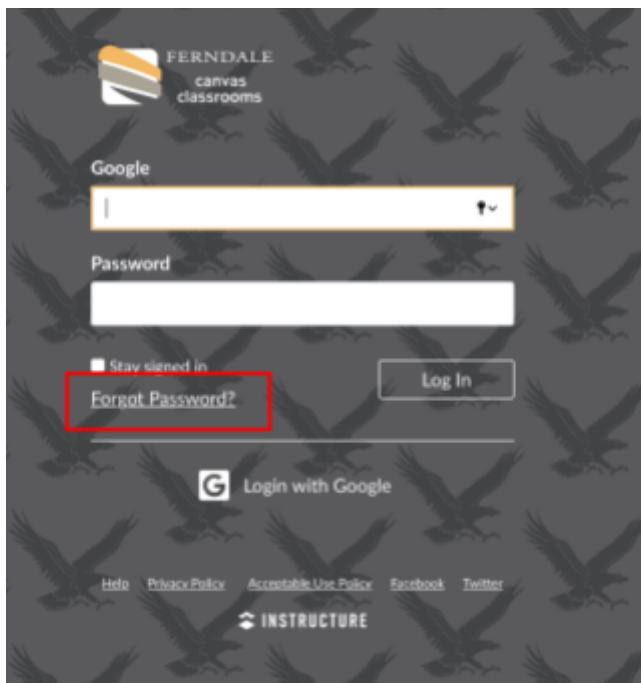

You can also use your Canvas account to take advantage of the Canvas Parent App. Once you download the app, you can use your credentials to login to the app. You can also generate a QR code from your Canvas online account, to make it easier to login to the app.

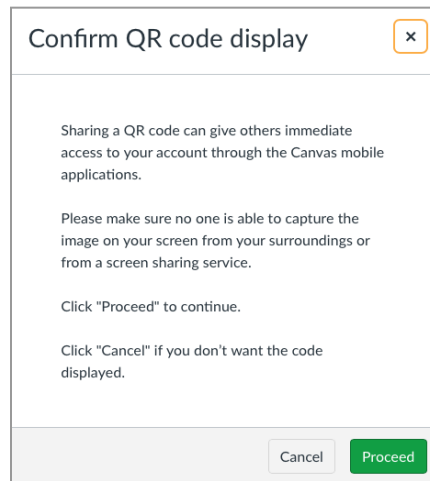
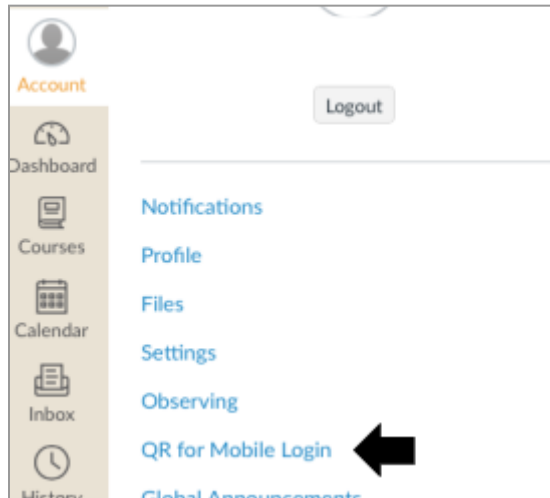

Click Proceed >

The next screen will have your QR code which will log you directly into your Canvas account.

Here is a link to the Canvas app user guides: [Canvas Users Guide](#)

I'll share more information about the parent app and Canvas observer role in the near future, but here is a summary of what you can do as an observer and with the Canvas Parent App. Here is a link to a summary of observer permissions: [Observer Permissions](#)

These accounts were generated from working emails submitted to MISTAR (contact 1 and contact 2). If you are not able to access your Canvas account, please email Tom Maes ([john.maes@ferndaleschools.org](mailto:john.maes@ferndaleschools.org)).

Please do not hesitate to reach out to me if you have any questions regarding Canvas.

Tom Maes

[john.maes@ferndaleschools.org](mailto:john.maes@ferndaleschools.org)

248-586-8666